

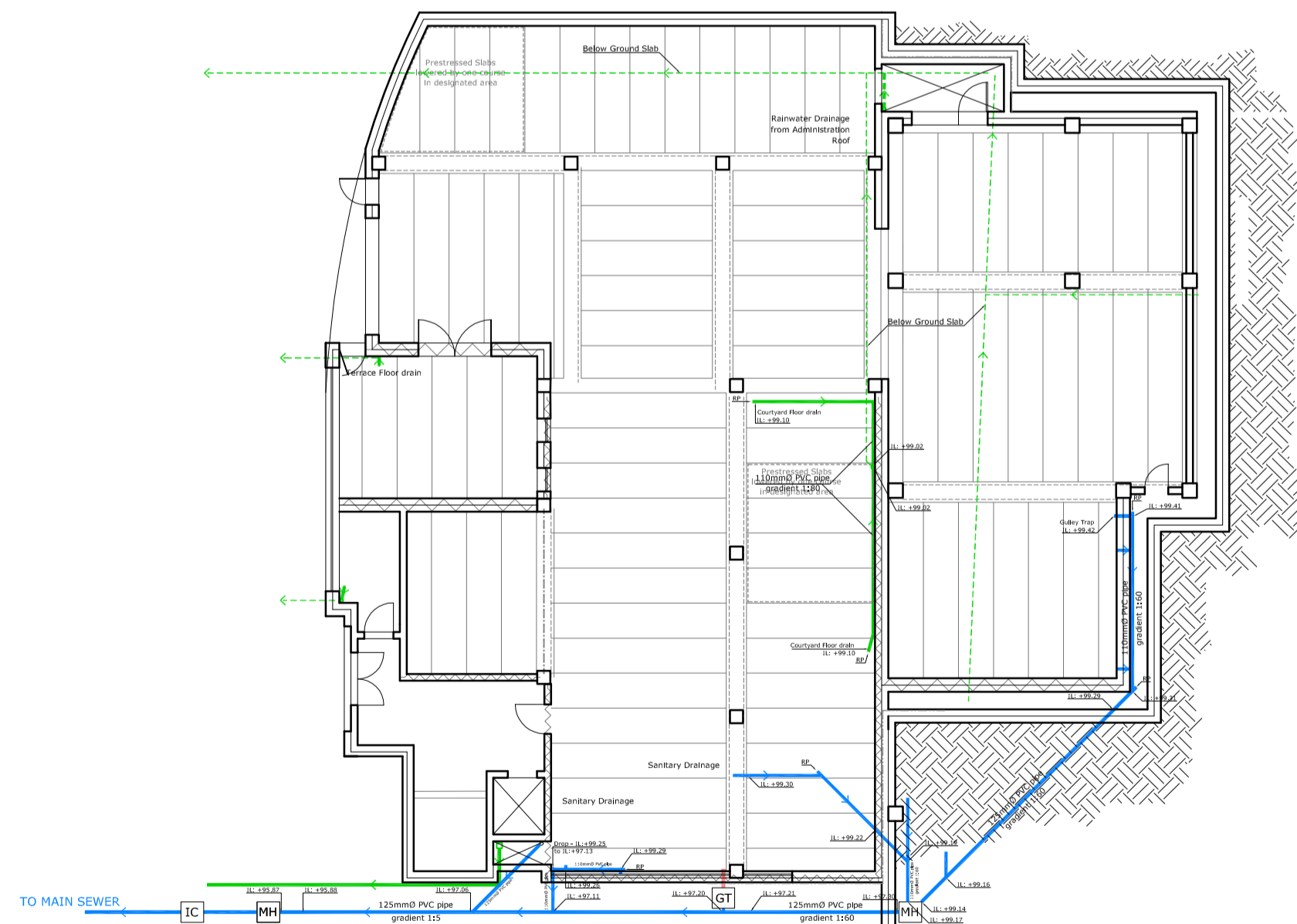

1 PLAN - Level 0
Scale 1:200

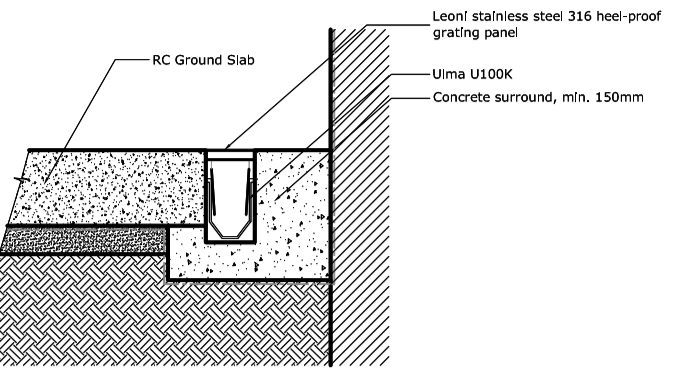

2 PLAN - Reflected Ceiling Level 0
Scale 1:200



3 Detail Channel Drain
Scale 1:20

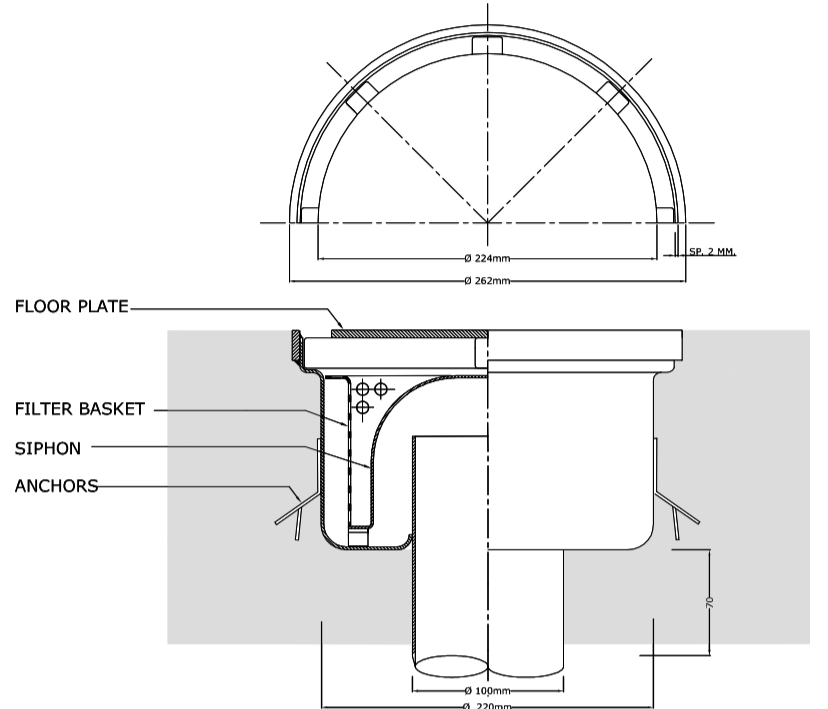

4 Detail S/S Drain Type FD1
Scale 1:20

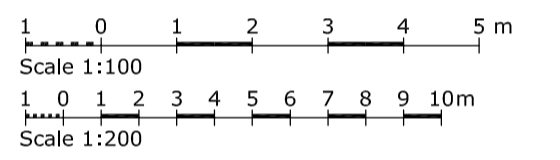

LEGEND:

- Process Drainage 110/150mmØ HDPC Pipe
Rainwater 200mmØ PVC Pipe
Process Drainage Channel
Water Discharge 60mmØ PVC Pipe
Sanitary Drainage 100/125mmØ PVC Pipe

- NRV (Non-return valve)
GT Gully Trap
MH Manhole
FD Floor Drain
IC Interceptor Chamber
RP Rodding Point

H	Amended drains for flammable warehouse extension	15/05/15
G	Amended drain layout in loading/unloading area	12/12/11
F	Included of invert levels & modified gradients	18/10/11
E	Inclusion of Drain in Rm34	15/09/11
D	Changes in Drains Layout	07/09/11
C	Changes in Drains Layout	24/08/11
B	Included FD2 and change detail Channel drain	25/05/09
A	-	--/--/--

Wallace Farrugia & Associates Architects, Civil Engineers & Structural Consultants. No 44, Apt 3, St.Francis Street, Slemo SLM5 tel:21316758 fax: 21316760	
Commission: Proposed Factory at Hal-Far	
Client: STERLING SNIFF	
Drawing Title: Drainage Layout	
Scale: 1:200	Drawing No: 38-06-100H
Job Ref: 38/06	A B C D E F G H
Drawn: az	Traced: --
Approved: --	Checked: w.f.
Date: 16/09/08	